



## 400SCB/424 Speed Control Board

### Technical information and features

- Speed control ratio 20:1
- Remote speed control
- Compact design
- Optimised for 400FDC, 313/314FDP and 501FDP
- Runs directly off main supply
- Delivered with a remote potentiometer (10Kohm)



400SCB/424 Speed Control Board with remote potentiometer (10Kohm)

### 400SCB

*These OEM motor speed controls are designed for operating permanent magnetic DC motors 5 or 30 watts. They are linear type controllers that provide smooth acceleration and deceleration under load, and a turndown of 20:1.*

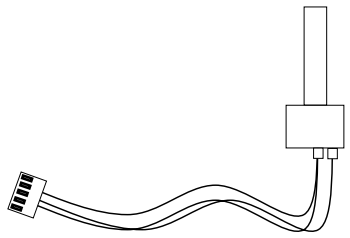
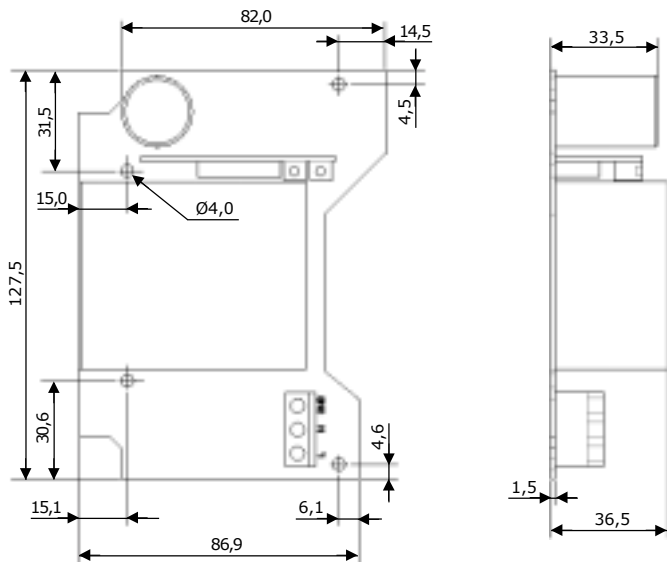

- Remote potentiometer (10Kohm)
- 1 meter cabling

Product codes 400SCB/424		
Supply Voltage	0-12VDC, 5W motor	0-21VDC, 30W motor
100-115VAC 50/60Hz	049.C424.05A	049.C424.30A
220-240VAC 50/60Hz	049.C424.05E	049.C424.30E

## 400SCB/424

### Specifications

Speed control ratio	20:1 (stable, speed independent of load)
Remote speed options	0-20 mA or 4-20 mA, 0-1V or 0-10V, remote potentiometer (10Kohm)
User adjustments	Max speed and signal selection
Temperature range	-30°C to 40°C
Supply voltage	110-115VAC 50/60 Hz or 220-240VAC 50/60 Hz
Output voltage	0-12VDC, 5W or 0-21VDC, 30W



W-M Alitea AB  
 Solkraftsvägen 35  
 SE-135 70 Stockholm  
 SWEDEN  
 Tel: +46 8 556 556 00  
 Fax: +46 8 556 556 25  
 www.alitea.se  
 Email: info@alitea.se

You can download the latest edition of this data sheet at [www.alitea.se](http://www.alitea.se).  
 W-M Alitea reserves the right to alter specifications without notice.